

INST_17_5

1

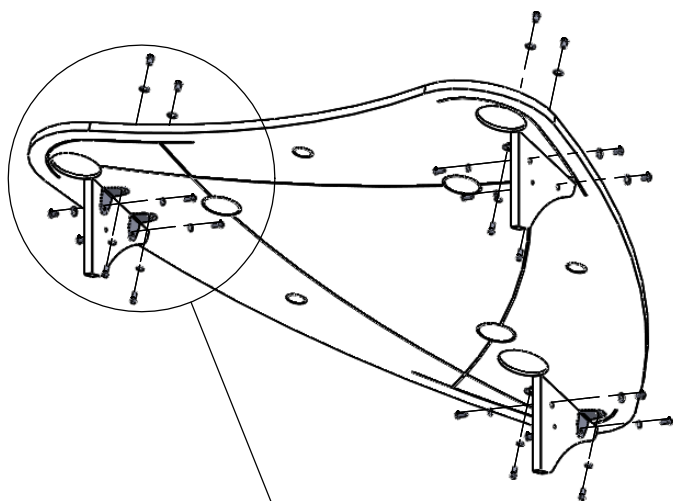

Nr	Σ	Element	DIN	ELEMENT
10	3		DIN 9021	6x18
16	3		-	K1_d21_B
17	3		-	Z1_d21_B
18	3		DIN 985	M6
21	12		DIN 125	8x16
22	15		DIN 125	6x12
24	12		ISO 7380	M6x16
25	3		ISO 7380	M6x35
29	6		-	K_5_A2_g2_ G_v2
147	12		-	M6x10

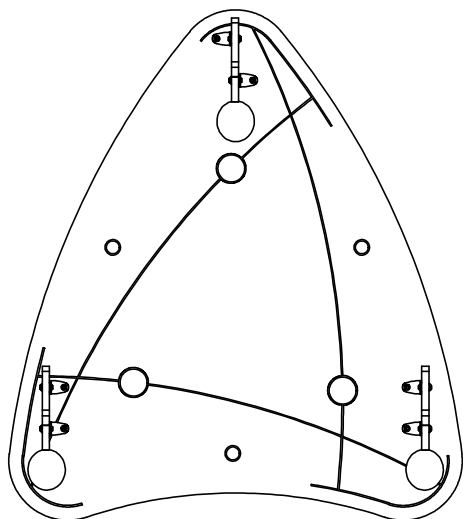
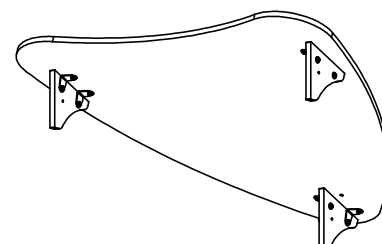
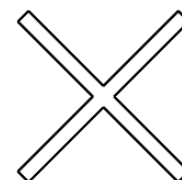
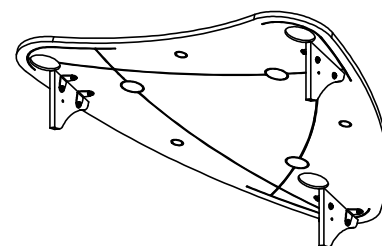
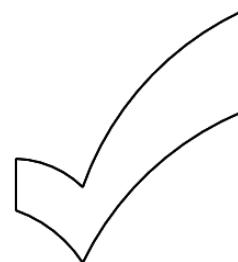
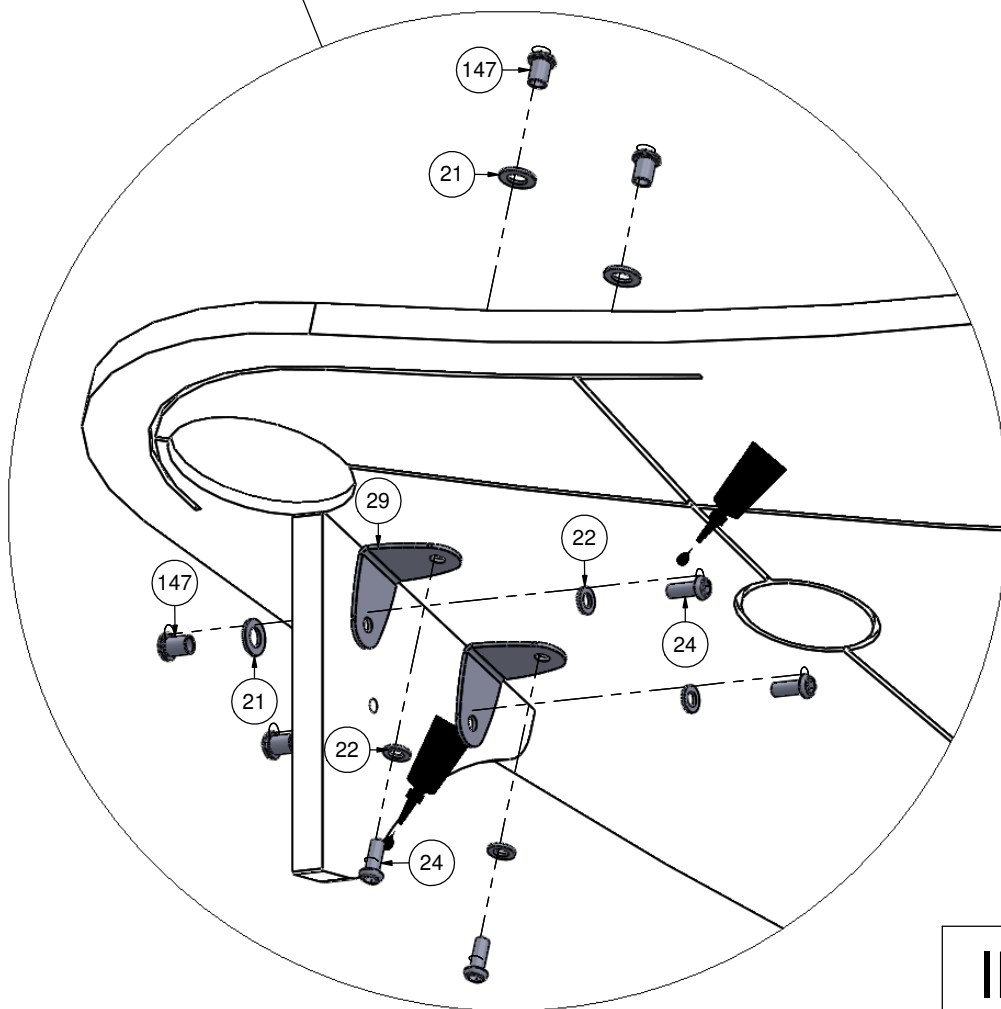

INST_17_5

1/2

2

