

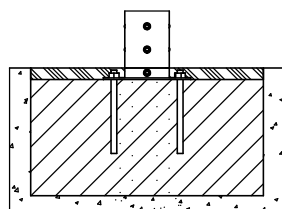

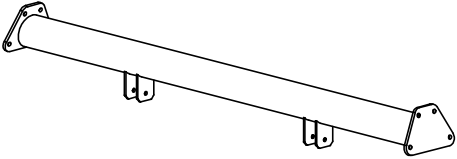

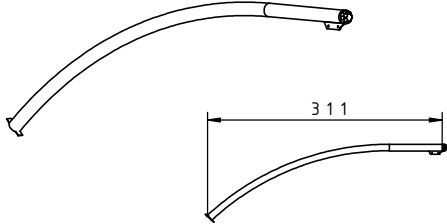

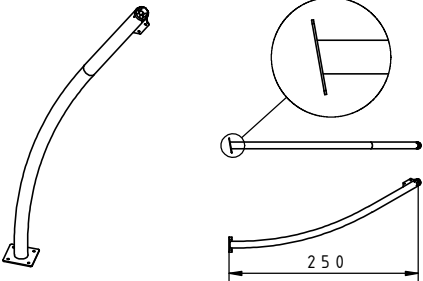
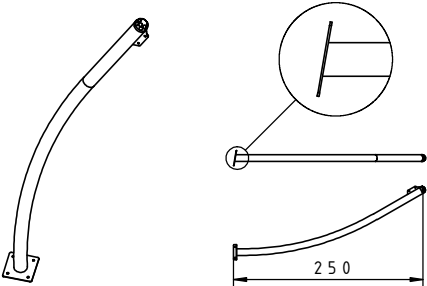
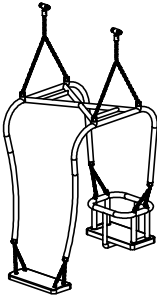
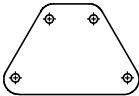
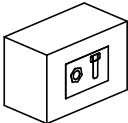

3033N

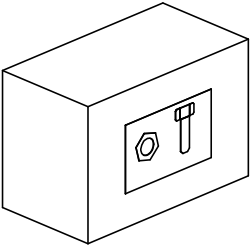

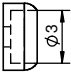
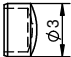
3033F

3033

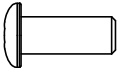
NR	ELEMENT	3033N	3033F
E1		1	1
E2		4	
E2a			2
E2b			2
E3		1	1
E4		2	2
E5		1	1

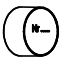
				3033N	3033F
Nr	Element			Σ	Σ
4		DIN 125	10x20	16	16
3		-	K2_d30_B	4	4
6		-	Z2_d30_B	4	4
57		DIN 1587	M10	8	8
58		-	LOCTITE	1	1
61		-	KL105		16
79		ISO 7380	M10x40		8
213		-	Z_NA_1	1	1
214		-	Z_NA_2	1	1

3033N

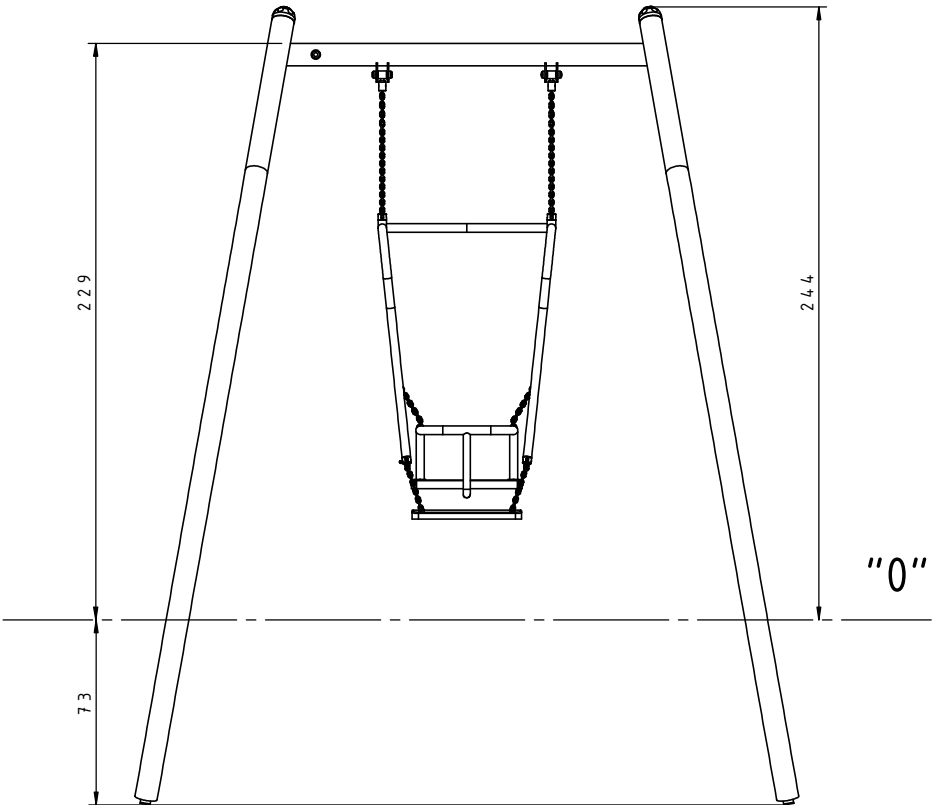

3033F

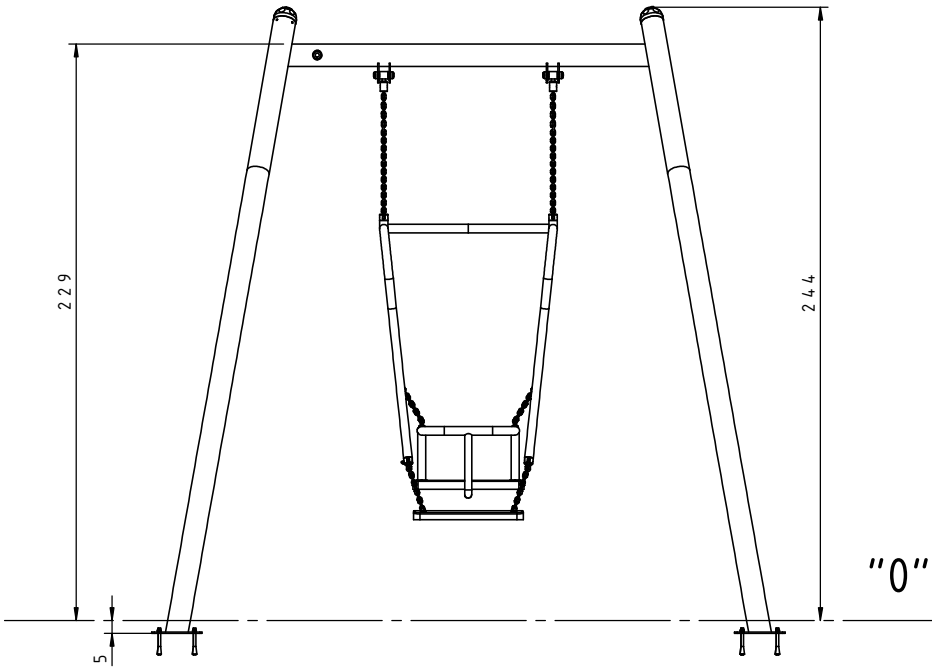

3033N
3033F

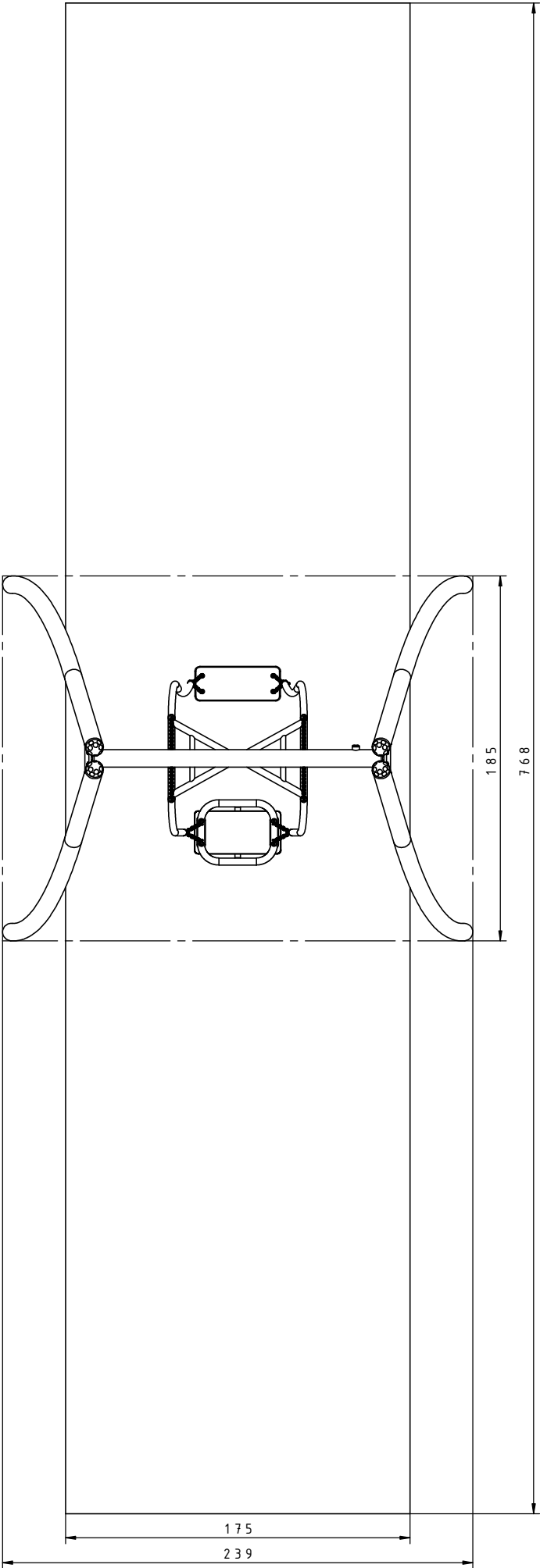

3024N

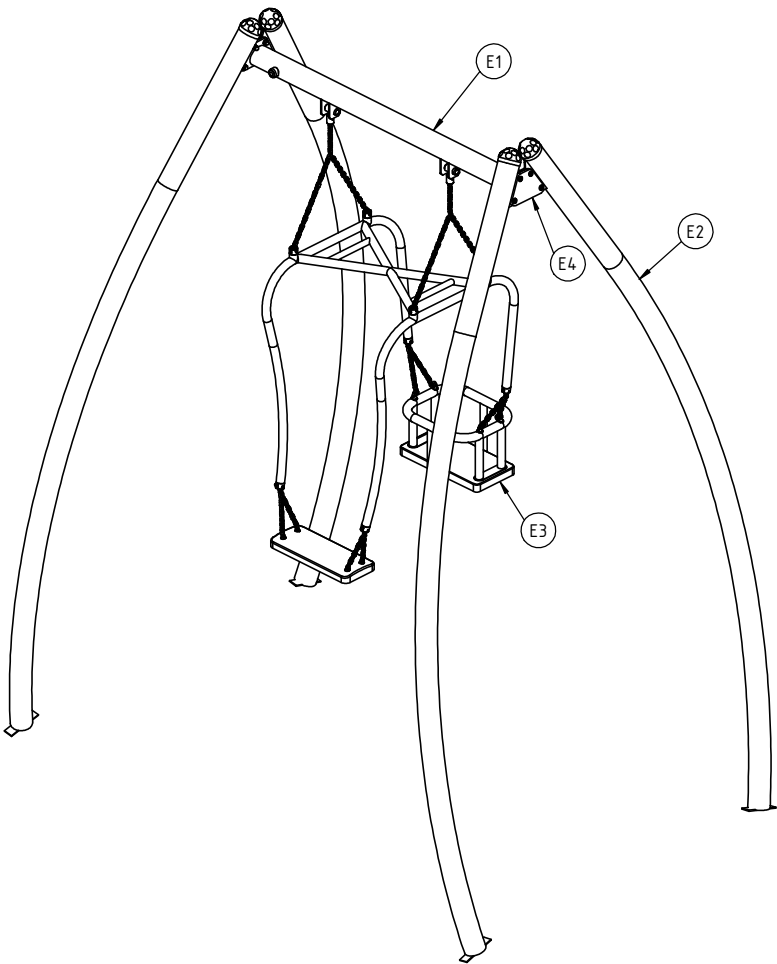

3024F

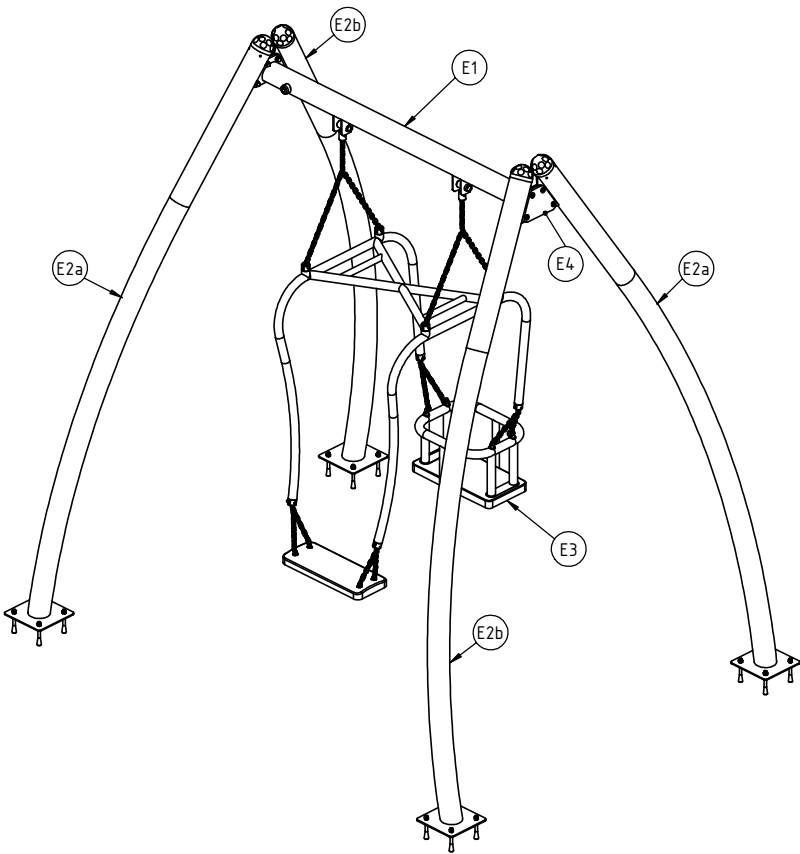

1

3033N
3033F

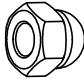
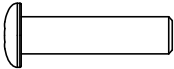
Nr	Σ	Element		
4	16		DIN 125	10x20
57	8		DIN 1587	M10
79	8		ISO 7380	M10x40

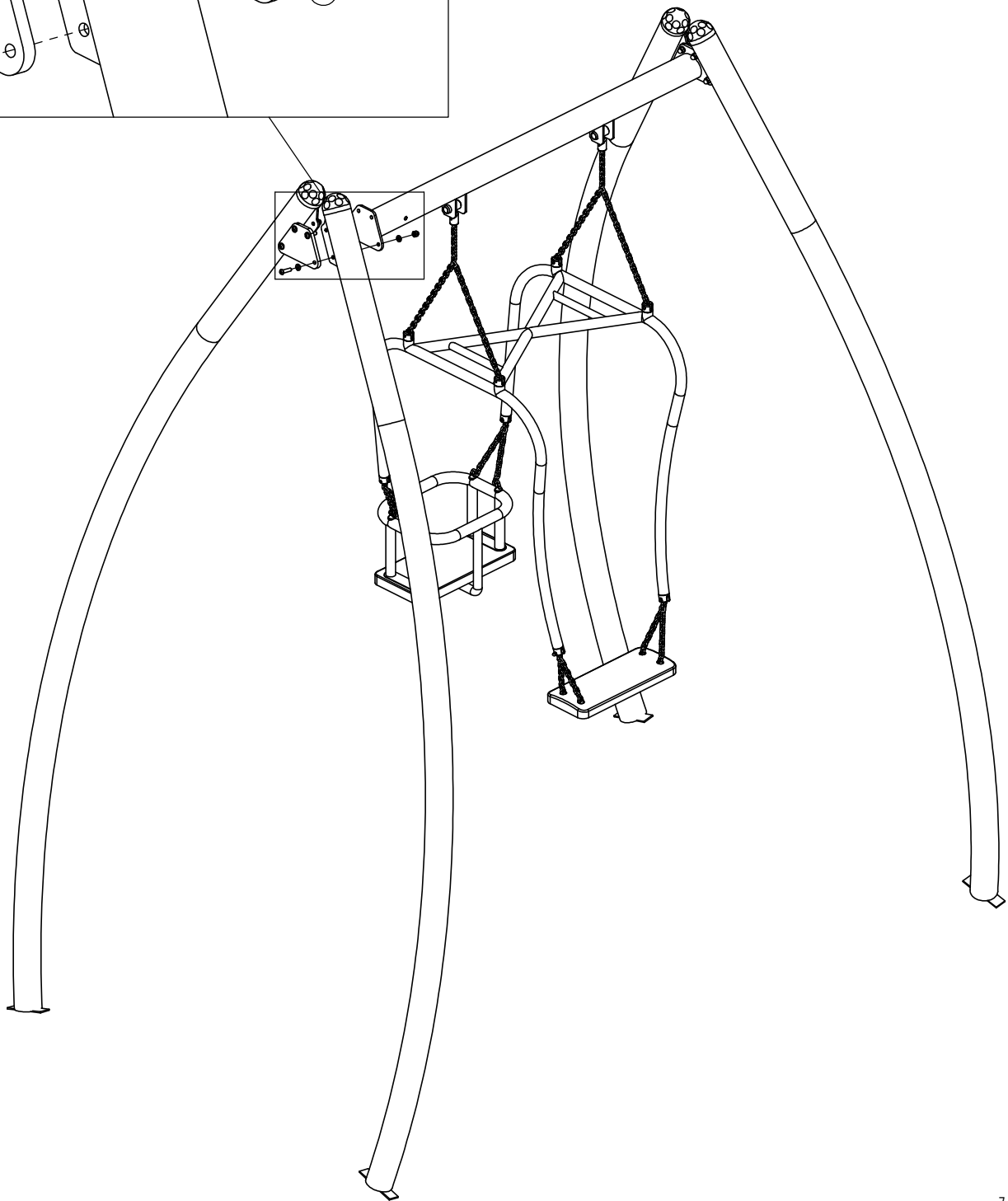
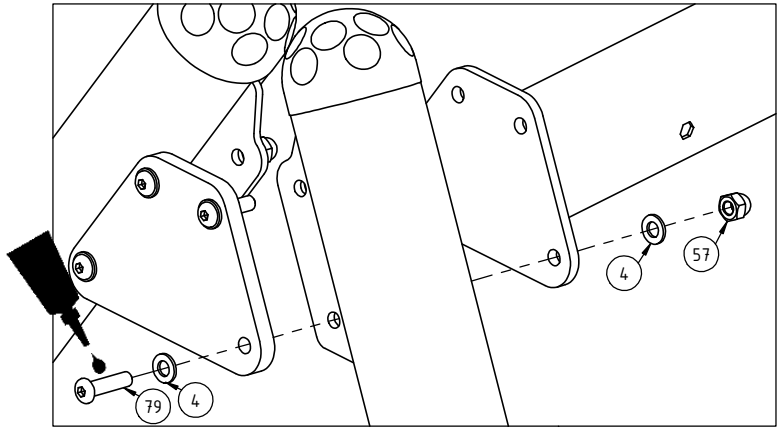

2

3033N

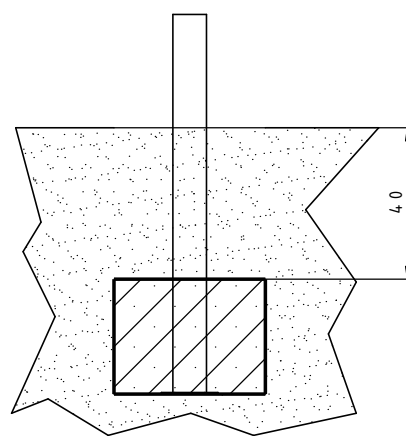
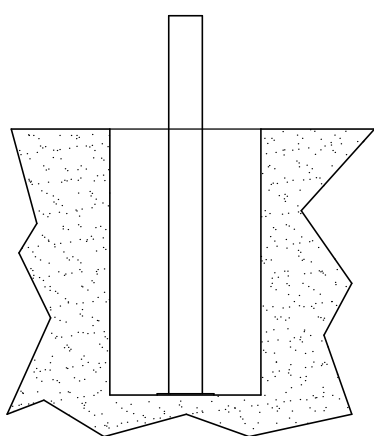
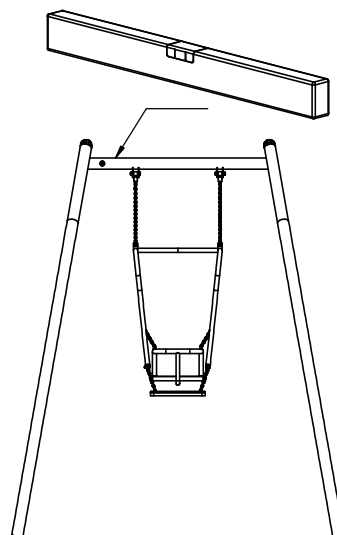
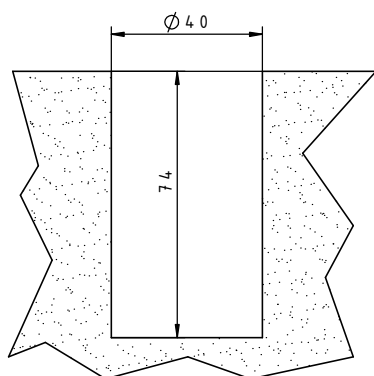
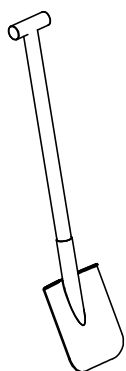
B15 0,3m³

min. 48H

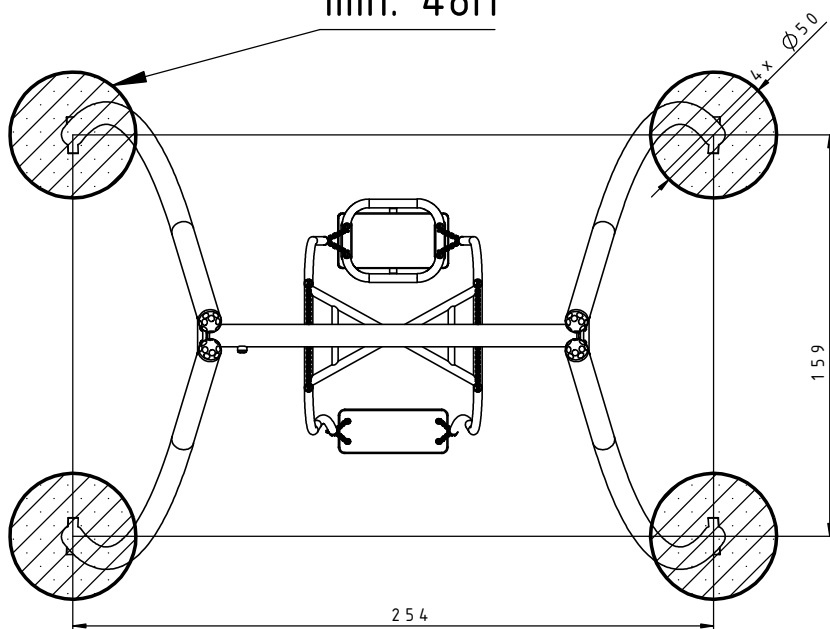

2

3033F

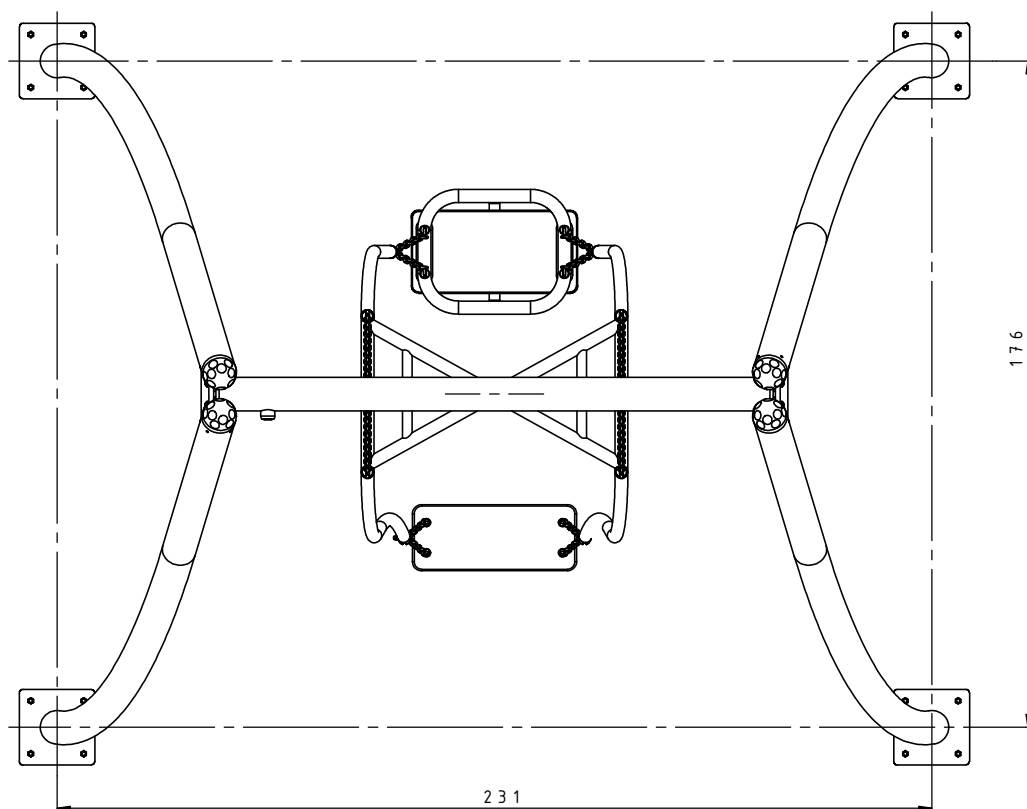
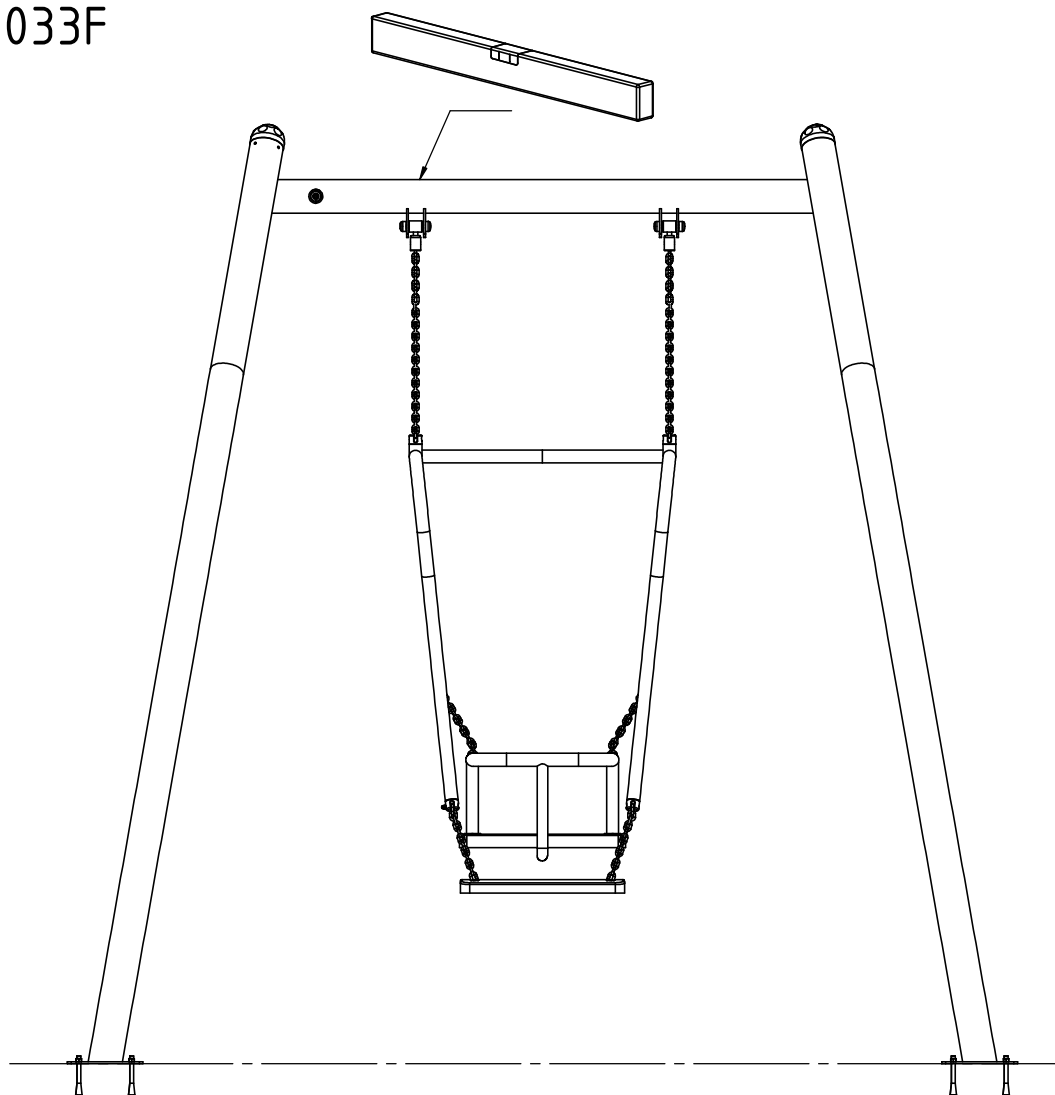

2 3033F

Nr	Element		
61		-	KL105

I

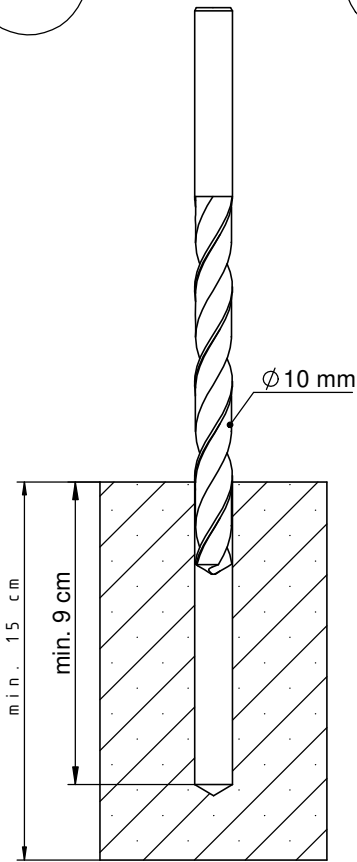

II

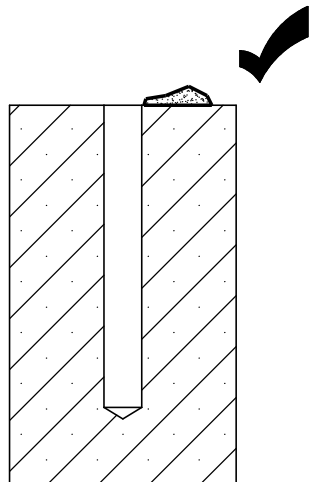
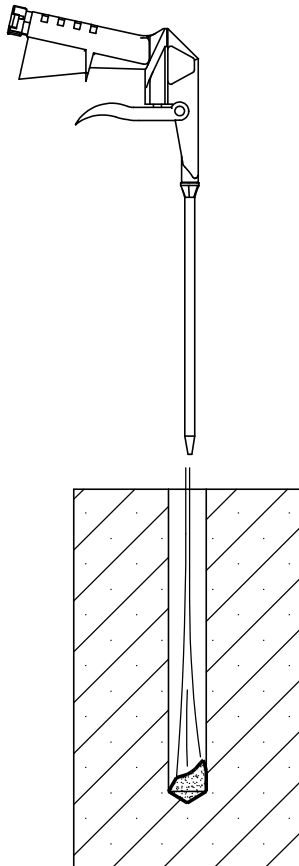

III

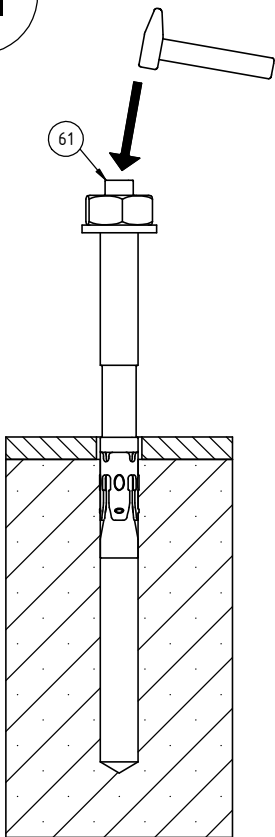

IV

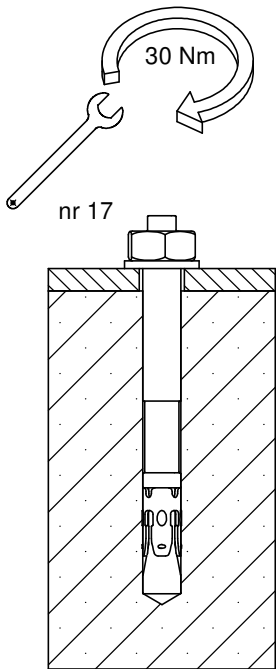

V

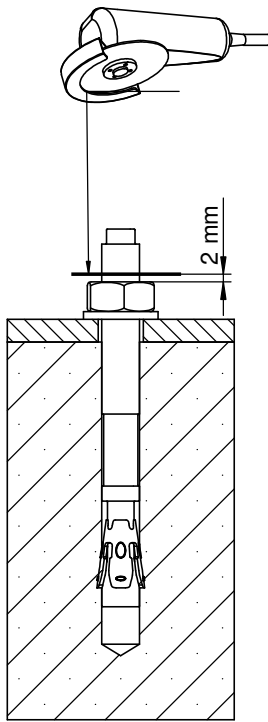

VI

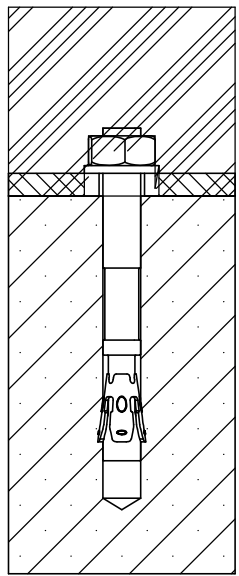

3

3033N
3033F

